

Datasheet

Touch for Nano US

Part No: 100427



About the product

With our Loxone Touch in 1-gang box size, you can declutter walls and control essential functions with a stylish and intuitive control element for new builds or retrofit. With just a tap on one of its five Touch points, you can control lighting, blinds, music and more according to the Loxone Switch Standard.

Technical data

Power Supply	via Nano Relay Air
Power Consumption	-
Power Loss	-
Ambient Temperature	-20 ... 70°C / -4 ... 158°F
Humidity	max. 95% r.H. (non condensing)
Touch Points	5 Touch Points, capacitive touch detection
Click Feedback	Yes

Connection diagram

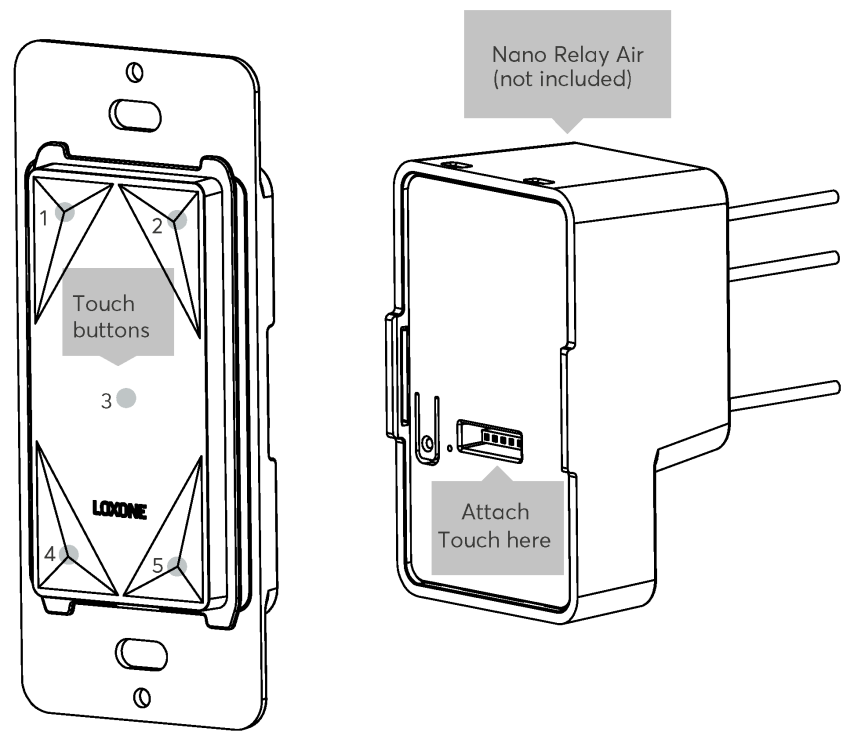

Product features

Colours	White RAL9003
Finish	Matte

Weight & dimensions

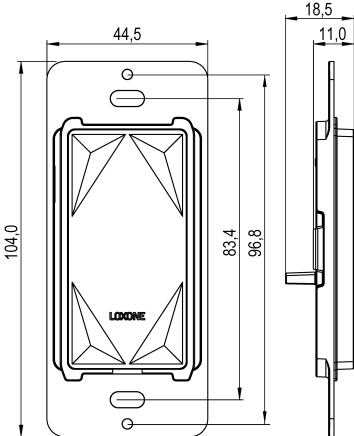
Net weight	28g
Total weight	52g
Product dimensions	Touch for Nano: 104x44,5x18,9mm / 4.09x1.75x0.74" (LxWxH) Nano Relay Air with Nano: 104x45x44mm / 4.09x1.77x1.73" (LxWxH)
	 <p>The technical drawing shows two views of the device. The front view is a rectangle with a width of 44.5 mm and a height of 104.0 mm. It features a central display area with a 'LOCKING' label and four corner buttons. The side view shows a thickness of 18.5 mm and a mounting bracket with a height of 11.0 mm. Other dimensions include 83.4 mm for the inner display area and 96.8 mm for the outer frame.</p>
Pack size	115x80x28mm / 4.53x3.15x1.10" (LxWxH)

Certifications & Standards

Safety Rating	IP30
Operation	Type 1 (EN60730-1)
Degree of Pollution	2
Certifications	UL60730-1 IEC60730-1 RECOGNIZED COMPONENT  Intertek

Installation must be carried out by a qualified electrician in accordance with the relevant regulations.

Datasheet

Touch for Nano US

Artikel Nr.: 100427



Über das Produkt

With our Loxone Touch in 1-gang box size, you can declutter walls and control essential functions with a stylish and intuitive control element for new builds or retrofit. With just a tap on one of its five Touch points, you can control lighting, blinds, music and more according to the Loxone Switch Standard.

Technische Daten

Power Supply	via Nano Relay Air
Power Consumption	-
Power Loss	-
Ambient Temperature	-20 ... 70°C / -4 ... 158°F
Humidity	max. 95% r.H. (non condensing)
Touch Points	5 Touch Points, capacitive touch detection
Click Feedback	Yes

Anschlussplan

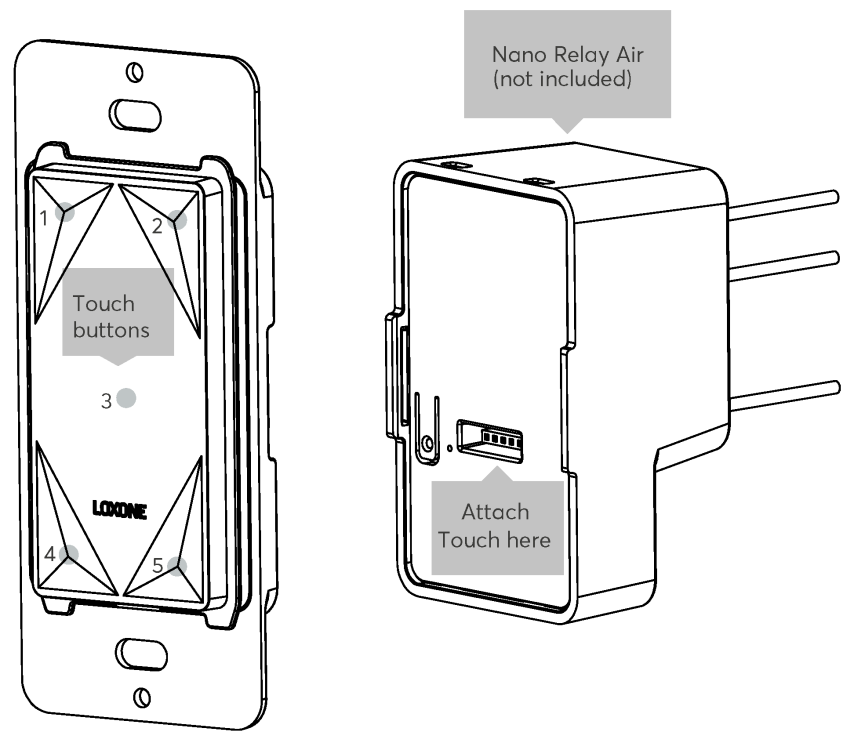

Produkteigenschaften

Colours	White RAL9003
Finish	Matte

Gewicht & Abmessungen

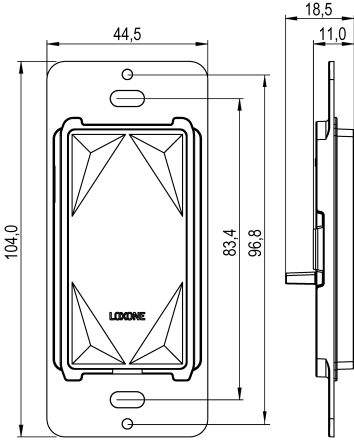
Net weight	28g
Total weight	52g
Product dimensions	Touch for Nano: 104x44,5x18,9mm / 4.09x1.75x0.74" (LxWxH) Nano Relay Air with Nano: 104x45x44mm / 4.09x1.77x1.73" (LxWxH)
	
Pack size	115x80x28mm / 4.53x3.15x1.10" (LxWxH)

Zertifizierungen & Standards

Safety Rating	IP30
Operation	Type 1 (EN60730-1)
Degree of Pollution	2
Certifications	UL60730-1 IEC60730-1 RECOGNIZED COMPONENT  Intertek

Installation must be carried out by a qualified electrician in accordance with the relevant regulations.
Veröffentlicht von

Loxone Electronics GmbH

Smart Home 1

4154 Kollerschlag

Austria

Tel: +43 7287 7070-0

loxone.com